



SKYLINE[®]

C A B I N E T R Y



About Us

Skyline Cabinetry is a premier wholesaler of KCMA certified kitchen and bath cabinetry. We have an exemplary reputation of providing superior product, short lead times, competitive pricing, and world-class customer service.

We are the world's fifth largest cabinet manufacturer, importing to the United States for the last 12 years. We have manufacturing plants in Asia and Russia with over 4,600 production associates worldwide. Our manufacturing capacities exceeds 440,000 Cabinets per month with continued growth and expansion.



Our extensive product line capabilities include the following:

- ★ Traditional Framed
- ★ European Style Frameless
- ★ Builder Grade Series
- ★ Multi-Family

1	Finish	S = Stained P = Painted U = UV Finishing T = Thermofoil Finishing M = Melamine Finishing
2	Box Construction	P = Plywood Box B= Partical Board Box
3	Accessories	M = Metal Drawer Box S = Soft Close Glides E = Epoxy Glides

We have the capabilities to provide cabinets, countertops, sinks and door hardware along with installation services.

We have three large distribution centers conveniently located in Chicago, Dallas, and Orlando. Our locations carry over 50,000 cabinets with a normal 3 - 5 business day lead time for unassembled cabinets.

Our Frameless Construction custom options include your ideas and choices.



We recommend Thermofoil Finish instead of Melamine for Shaker Frameless



Table of Contents

Warranty.....	4
KCMA Certificate	5
Framed Cabinet Construction	7
Framed Cabinet Styles	8
How to Order	9
Framed Wall Cabinets	10-23
Base Cabinets	24-31
Pantries	32-36
Vanities	37-39
Moulding	40-42
Framed Filler & Panels	43-45
Accessories	46-47



SKYLINE[®]

C A B I N E T R Y

WARRANTY

Limited 12 Month Warranty

Skyline Cabinetry Inc. warrants to the original consumer purchases that Skyline Cabinetry cabinets, door hinges, and drawer glides will be free from defects in material and workmanship under normal use and service for twelve months (Proof of Purchase is required). This warranty is not transferable and only applicable to product used for residential purposes. Representatives of Skyline Cabinetry do not have the authority to change or enlarge this warranty.

This warranty does not cover normal wear and tear, damage or defects caused by accidents, misuse, abuse, lack of necessary maintenance or acts of God; nor does it cover alteration, modification, improper installation, improper handling / storage, environmental conditions, nor any labor expenses.

Skyline Cabinetry Inc., at our option, may elect to repair or replace with a functionally equivalent product any Skyline Cabinetry product covered by this warranty. Some replacement parts are subject to availability and may differ from original parts received. Return of defective product may be required for a replacement to be issued. Repair parts or replacement parts are at the expense of Skyline Cabinetry Inc., but customer shall bear all other expenses. These expenses may include, but are not limited to, cost of removal and re-installation of product, labor expenses, etc.

The variation in color and grain pattern in wood adds to its natural beauty and is not considered an imperfection. Environmental factors, including but not limited to artificial / natural light, moisture, cleaners, smoke, etc., may cause the darkening or mellowing of a cabinet over time. This is a natural process and can be expected. This warranty does not cover the natural aging or darkening / mellowing of wood color, the inherent growth characteristics of, or variation in wood.

Some of the cabinet lines feature a glazed finish which accentuates the door and drawer front profiles. This glaze is hand applied over a stain or paint and may, due to the nature of application, consist of random drips, runs, etc. As glazing is a hand applied process there will be variations in color and appearance from door to door and cabinet to cabinet. This is not considered a defect and is considered normal with hand applied finishes. It is the nature of wood to expand and contract to varying degrees depending on climate conditions. As a result, cabinet lines with painted surfaces may show fractures in the paint at joints. This is normal and is not considered a defect.

This warranty is valid only in the United States of America and is not transferable. All implied warranties are limited in duration to the shorter of the period provided by law or the period of this warranty. To the extent permitted by law, this warranty excludes special, incidental, or consequential damages. Some states do not allow the exclusion or limitations of incidental or consequential damages or limitations on how long an implied warranty lasts, so the above limitations or exclusions may not apply to you. This warranty gives you specific legal rights; you may have other rights which vary from state to state. To exercise this warranty, please contact the Skyline Cabinetry supplier from whom you purchased the product.



ANSI/KCMAA161.1

Certificate Number: 22038
Issue Date: June 15, 2022
Expiration Date: August 31, 2023
Supersedes Certificate No.: 22044

LISTING

C E R T I F I C A T E

THIS CERTIFIES THAT

Skyline Cabinetry
Farmers Branch, TX

is a current participant in the Kitchen Cabinet Manufacturers Association Certification Program and is manufacturing the following lines of kitchen cabinets and/or bathroom vanity cabinets in conformance with American National Standard ANSI/KCMAA161.1-2022, *Performance and Construction Standard for Kitchen and Vanity Cabinets*:

Factory Assembled

Charleston Saddle
Charleston White

Shaker Espresso
Shaker Grey

Shaker White

These cabinet lines are listed in the Kitchen Cabinet Manufacturers Association Directory of Certified Cabinet Manufacturers. This manufacturer is authorized to apply KCMA Certification Seals to the factory assembled kitchen and bath cabinet lines listed above. Flat pack (unassembled) cabinets, if sold by this manufacturer, are not certified.

This certificate may be updated at any time and will expire on the date listed above. This certificate may also be canceled for non-conformity with the requirements of the Certification Program or upon voluntary withdrawal from the program by the manufacturer.

Charles P. Arnold
Vice President Standards & Certification

This certificate is current as of the issue date
Current listing information is at www.kcma.org



Cabinet Construction Framed



1. Full overlay panel, $\frac{3}{4}$ inch thick solid wood
2. 6-way adjustable European-style hinge with soft-close feature
3. Shelving is $\frac{3}{4}$ inch thick cabinet-grade plywood with front edge banding
4. Dovetail drawers with solid wood on all sides, full extension
5. Concealed under-mount full extension drawer glides with soft-close feature
6. $\frac{1}{2}$ inch cabinet-grade plywood box, UV coated natural plywood on interior
7. Bracket reinforcements for base cabinet
8. Double-doweled face frame joint
9. Hardwood face frame
10. Door bumpers

Shaker

- Full overlay panel door and drawer front.
- $\frac{3}{4}$ inch thick solid wood frame with MDF center.
- $\frac{3}{4}$ inch thick cabinet grade plywood shelving with front edge banding.
- Dovetail drawers with solid wood on all sides.
- $\frac{1}{2}$ inch cabinet-grade plywood box.
- UV coated natural plywood interior.
- Concealed undermount full extension drawer glides with soft close feature.
- 6 way adjustable European style hinge with soft close feature.
- Door bumpers

Charleston

- Full overlay panel, $\frac{3}{4}$ inch thick solid wood frame.
- $\frac{3}{4}$ inch thick cabinet grade plywood shelving with front edge banding.
- Dovetail drawers with solid wood on all sides.
- $\frac{1}{2}$ inch cabinet grade plywood box with finished exteriors.
- UV coated natural plywood interior.
- Concealed undermount full extension drawer glides with soft-close feature.
- 6 way adjustable European style hinge with soft close feature.
- Door bumpers.

Shaker Style



SE
Shaker Espresso



SW
Shaker White



GR
Shaker Gray

Charleston Style



NB
Navy Blue
HDF



CW
Charleston White

*** Note that at this time not all cabinet SKU's are available in Navy Blue.

How to Order

Framed:

Specify the 2-letter door style (shown on page 6 of this book), followed by the product number for the cabinet.

Example:

W0930 would be the product number to use to order a Shaker White (SW) Wall Cabinet, 30" high, 9" wide and 12" deep.

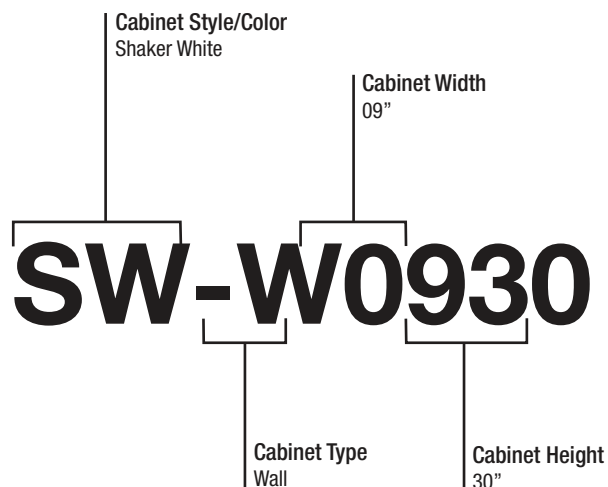

Important Note:

All framed boxes are finished. No additional panels are needed for the exposed side.

Wall Cabinet Single Glass Door

12"H

Item Code		W	H	D
W1212GD	Cabinet	12	12	12
	Door	11 1/2	11	3/4
W1512GD	Cabinet	15	12	12
	Door	14 1/2	11	3/4
W1812GD	Cabinet	18	12	12
	Door	17 1/2	11	3/4
W2112GD	Cabinet	21	12	12
	Door	20 1/2	11	3/4

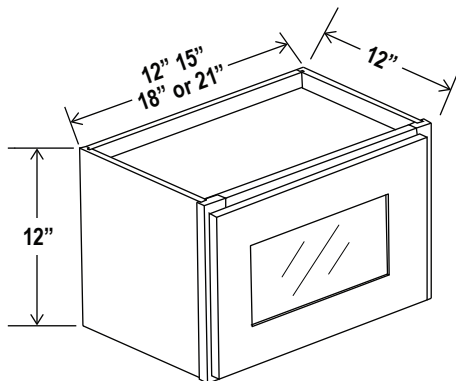

*Clear glass included
Color Matched Interior*

Wall Cabinet Double Glass Doors

12"H

Item Code		W	H	D
W2412GD	Cabinet	24	12	12
	Door	11 3/4	11	3/4
W2712GD	Cabinet	27	12	12
	Door	13 1/4	11	3/4
W3012GD	Cabinet	30	12	12
	Door	14 3/4	11	3/4
W3312GD	Cabinet	33	12	12
	Door	16 1/4	11	3/4
W3612GD	Cabinet	36	12	12
	Door	17 3/4	11	3/4

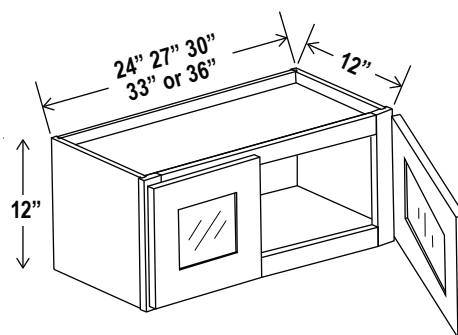

*Clear glass included
Color Matched Interior*

Wall Cabinet Double Doors

12"H

Item Code		W	H	D
W3012	Cabinet	30	12	12
	Door	14 3/4	11	3/4
W3312	Cabinet	33	12	12
	Door	16 1/4	11	3/4
W3612	Cabinet	36	12	12
	Door	17 3/4	11	3/4

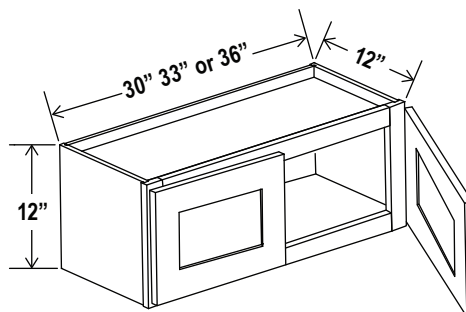

No shelf

15"H

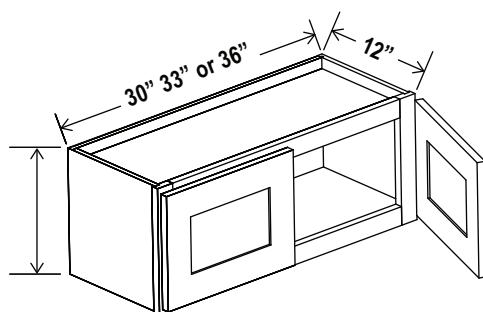

Wall Cabinet Double Doors

Item Code		W	H	D
W3015	Cabinet	30	15	12
	Door	14 3/4	14	3/4
W3315	Cabinet	33	15	12
	Door	16 1/4	14	3/4
W3615	Cabinet	36	15	12
	Door	17 3/4	14	3/4

No shelf

18"H

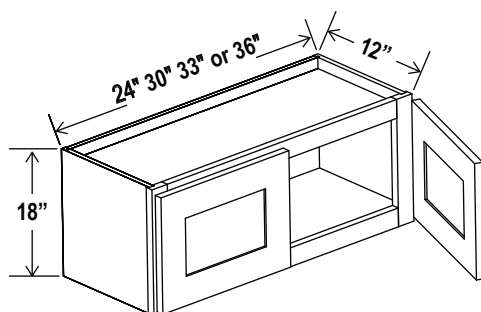

Wall Cabinet Double Doors

Item Code		W	H	D
W2418	Cabinet	24	18	12
	Door	11 3/4	17	3/4
W3018	Cabinet	30	18	12
	Door	14 3/4	17	3/4
W3318	Cabinet	33	18	12
	Door	16 1/4	17	3/4
W3618	Cabinet	36	18	12
	Door	17 3/4	17	3/4

No shelf

18"H

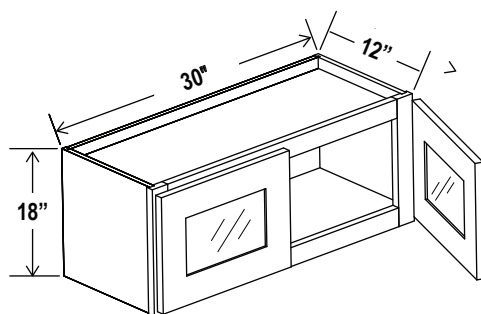

Wall Cabinet Double Glass Doors

Item Code		W	H	D
W3018GD	Cabinet	30	18	12
	Door	14 3/4	17	3/4

Clear glass included
Color Matched Interior

Wall Cabinet Double Doors

24"H

Item Code		W	H	D
W3024	Cabinet	30	24	12
	Door	14 3/4	23	3/4
W3324	Cabinet	33	24	12
	Door	16 1/4	23	3/4
W3624	Cabinet	36	24	12
	Door	17 3/4	23	3/4

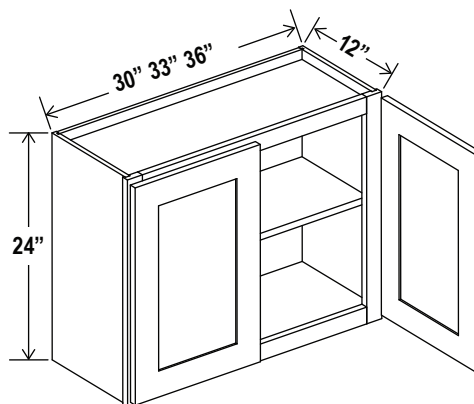

One adjustable shelf

Wall Cabinet Single Door

30"H

Item Code		W	H	D
W0930	Cabinet	9	30	12
	Door	8 1/2	29	3/4
W1230	Cabinet	12	30	12
	Door	11 1/2	29	3/4
W1530	Cabinet	15	30	12
	Door	14 1/2	29	3/4
W1830	Cabinet	18	30	12
	Door	17 1/2	29	3/4
W2130	Cabinet	21	30	12
	Door	20 1/2	29	3/4

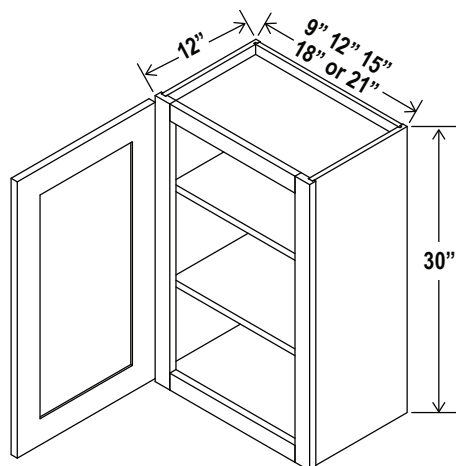

Two adjustable shelves

Wall Cabinet Single Glass Door

30"H

Item Code		W	H	D
W1530GD	Cabinet	15	30	12
	Door	14 1/2	29	3/4
W1830GD	Cabinet	18	30	12
	Door	17 1/2	29	3/4

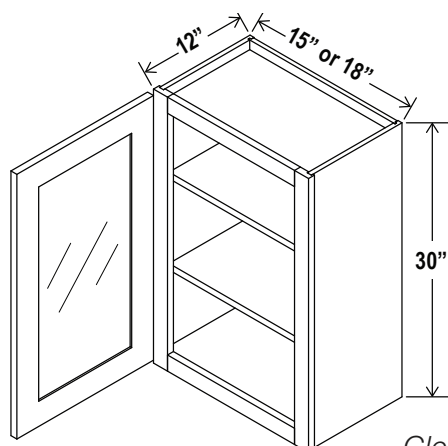

*Clear glass included
Color matched interior
Two adjustable shelves*

30"H

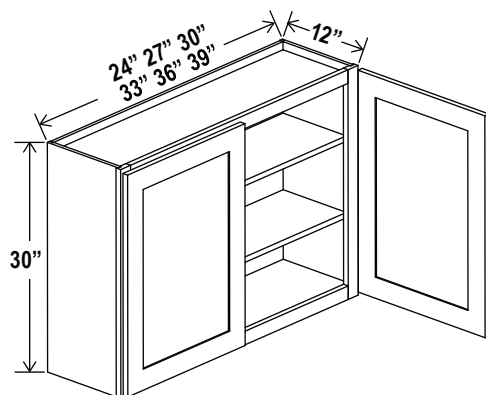

Two adjustable shelves

Wall Cabinet Double Doors

Item Code		W	H	D
W2430	Cabinet	24	30	12
	Door	11 3/4	29	3/4
W2730	Cabinet	27	30	12
	Door	13 1/4	29	3/4
W3030	Cabinet	30	30	12
	Door	14 3/4	29	3/4
W3330	Cabinet	33	30	12
	Door	16 1/4	29	3/4
W3630	Cabinet	36	30	12
	Door	17 3/4	29	3/4
W3930	Cabinet	39	30	12
	Door	19 1/4	29	3/4

30"H

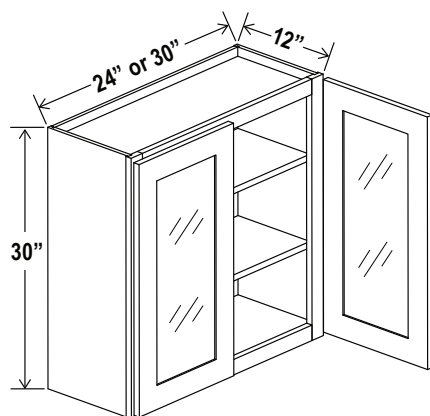

Clear glass included
Color Matched Interior
Two adjustable shelves

Wall Cabinet Double Glass Doors

Item Code		W	H	D
W2430GD	Cabinet	24	30	12
	Door	11 3/4	29	3/4
W3030GD	Cabinet	30	30	12
	Door	14 3/4	29	3/4

36"H

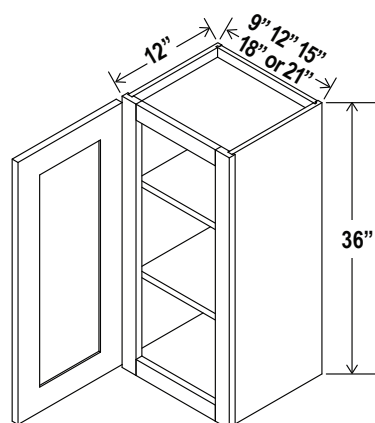

Two adjustable shelves

Wall Cabinet Single Door

Item Code		W	H	D
W0936	Cabinet	9	36	12
	Door	8 1/2	35	3/4
W1236	Cabinet	12	36	12
	Door	11 1/2	35	3/4
W1536	Cabinet	15	36	12
	Door	14 1/2	35	3/4
W1836	Cabinet	18	36	12
	Door	17 1/2	35	3/4
W2136	Cabinet	21	36	12
	Door	20 1/2	35	3/4

Wall Cabinet Single Glass Door

36"H

Item Code		W	H	D
W1536GD	Cabinet	15	36	12
	Door	14 1/2	35	3/4
W1836GD	Cabinet	18	36	12
	Door	17 1/2	35	3/4

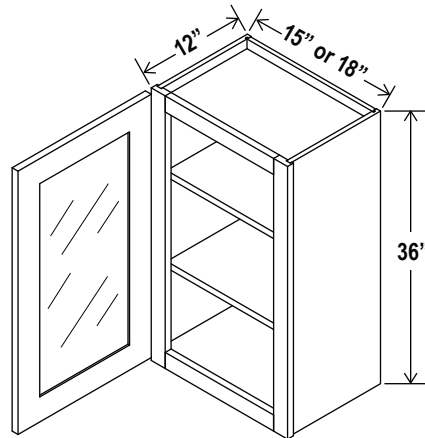

*Clear glass included
Color Matched Interior
Two adjustable shelves*

Wall Cabinet Double Doors

36"H

Item Code		W	H	D
W2436	Cabinet	24	36	12
	Door	11 3/4	35	3/4
W2736	Cabinet	27	36	12
	Door	13 1/4	35	3/4
W3036	Cabinet	30	36	12
	Door	14 3/4	35	3/4
W3336	Cabinet	33	36	12
	Door	16 1/4	35	3/4
W3636	Cabinet	36	36	12
	Door	17 3/4	35	3/4

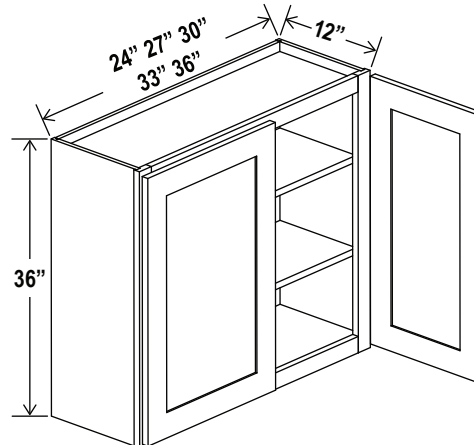

Two adjustable shelves

Wall Cabinet Double Glass Doors

36"H

Item Code		W	H	D
W2436GD	Cabinet	24	36	12
	Door	11 3/4	35	3/4
W3036GD	Cabinet	30	36	12
	Door	14 3/4	35	3/4

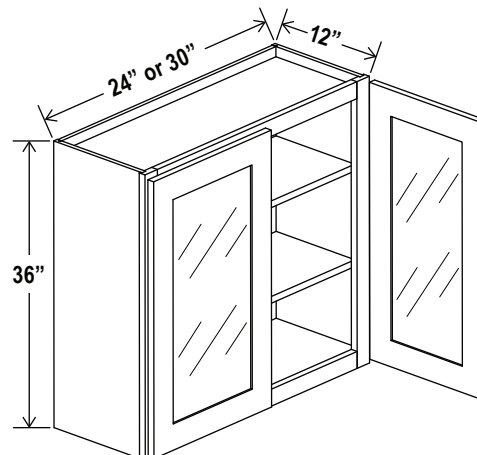

*Clear glass included
Color Matched Interior
Two adjustable shelves*

42"H

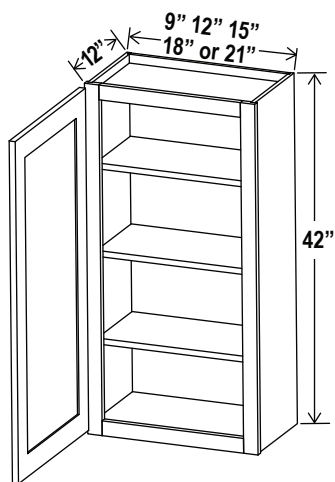

Three adjustable shelves

Wall Cabinet Single Door

Item Code		W	H	D
W0942	Cabinet	9	42	12
	Door	8 1/2	41	3/4
W1242	Cabinet	12	42	12
	Door	11 1/2	41	3/4
W1542	Cabinet	15	42	12
	Door	14 1/2	41	3/4
W1842	Cabinet	18	42	12
	Door	17 1/2	41	3/4
W2142	Cabinet	21	42	12
	Door	20 1/2	41	3/4

42"H

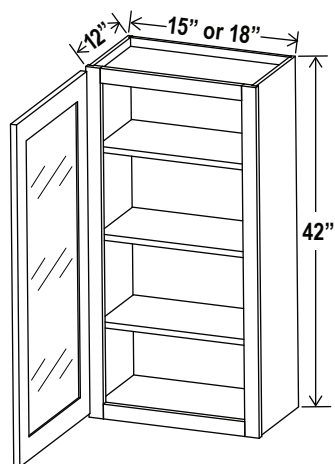

Clear glass included
Color matched interior
Three adjustable shelves

Wall Cabinet Single Glass Door

Item Code		W	H	D
W1542GD	Cabinet	15	42	12
	Door	14 1/2	41	3/4
W1842GD	Cabinet	18	42	12
	Door	17 1/2	41	3/4

42"H

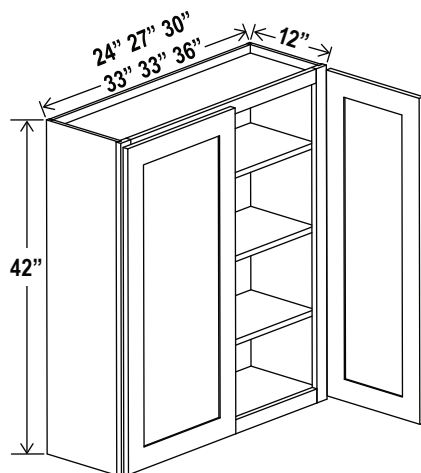

Three adjustable shelves

Wall Cabinet Double Doors

Item Code		W	H	D
W2442	Cabinet	24	42	12
	Door	11 3/4	41	3/4
W2742	Cabinet	27	42	12
	Door	13 1/4	41	3/4
W3042	Cabinet	30	42	12
	Door	14 3/4	41	3/4
W3342	Cabinet	33	42	12
	Door	16 1/4	41	3/4
W3642	Cabinet	36	42	12
	Door	17 3/4	41	3/4

Wall Cabinet Double Glass Doors

42"H

Item Code		W	H	D
W2442GD	Cabinet	24	42	24
	Door	11 3/4	41	3/4
W3042GD	Cabinet	30	42	12
	Door	14 3/4	41	3/4

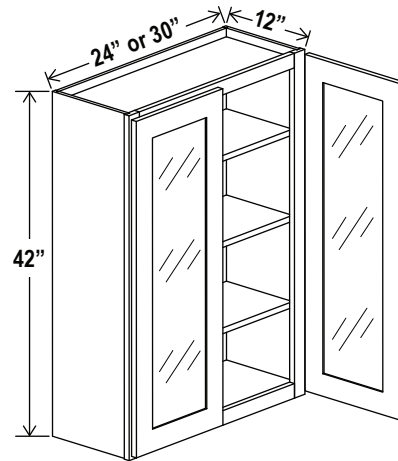

*Clear glass included
Color matched interior*

Diagonal Corner Wall Glass Door

24"W

Item Code		W	H	D
DCW2412GD	Cabinet	24	12	12
	Door	15 1/4	11	3/4

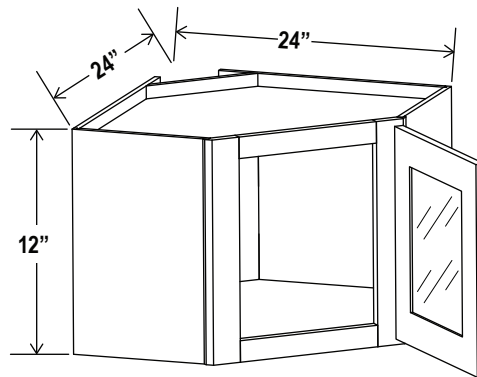

*Clear glass included
Color matched interior*

Diagonal Corner Wall Glass Door

24"W

Item Code		W	H	D
DCW2430GD	Cabinet	24	30	12
	Door	15 1/4	29	3/4
DCW2436GD	Cabinet	24	36	12
	Door	15 1/4	35	3/4
DCW2442GD	Cabinet	24	42	12
	Door	15 1/4	41	3/4

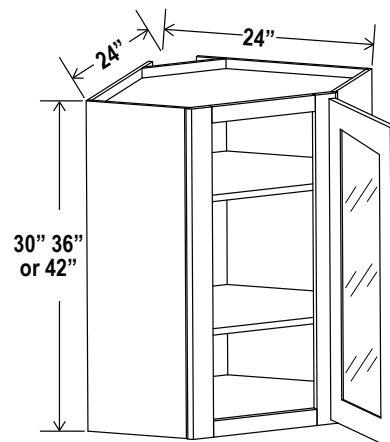

*Color matched interior
Two adjustable shelves*

24"W

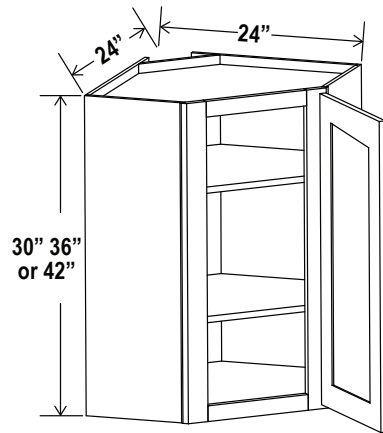

Two adjustable shelves (30"-36")
Three adjustable shelves (42")

Diagonal Corner Wall Single Door

Item Code		W	H	D
DCW2430	Cabinet	24	30	12
	Door	15 1/4	29	3/4
DCW2436	Cabinet	24	36	12
	Door	15 1/4	35	3/4
DCW2442	Cabinet	24	42	12
	Door	15 1/4	41	3/4

27"W

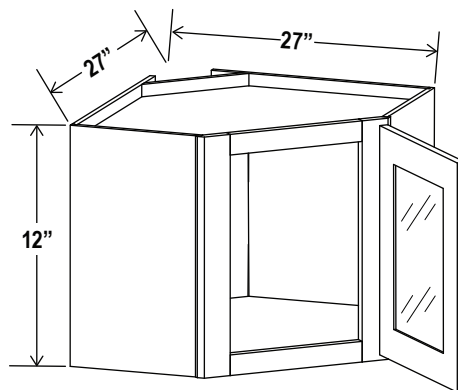

Clear glass included
Color matched interior

Diagonal Corner Wall Single Glass Door

Item Code		W	H	D
DCW2712GD	Cabinet	27	12	15
	Door	15 1/4	11	3/4

27"W

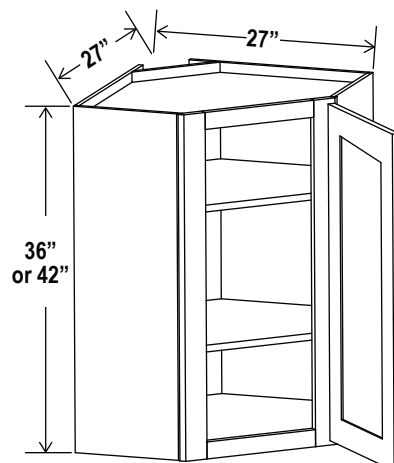

Two adjustable shelves (36")
Three adjustable shelves (42")

Diagonal Corner Wall Cabinet

Item Code		W	H	D
DCW2736	Cabinet	27	36	15
	Door	15 1/4	35	3/4
DCW2742	Cabinet	27	42	15
	Door	15 1/4	41	3/4

Wall Blind Corner Cabinet

30"H

Item Code		W	H	D
WBC2430	Cabinet	24	30	12
	Door	9 9/16	29	3/4
WBC2730	Cabinet	27	30	12
	Door	12 9/16	29	3/4
WBC3630	Cabinet	36	30	12
	Door	21 9/16	35	3/4

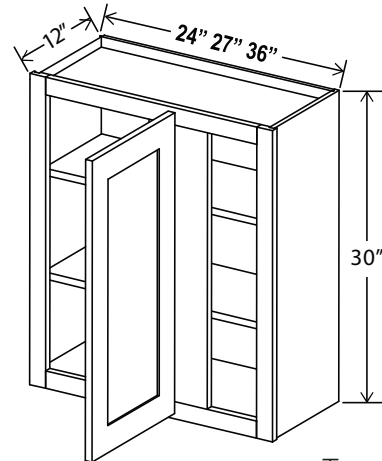

*Two adjustable shelves
Can be pulled for exact fit*

Wall Blind Corner Cabinet

36"H

Item Code		W	H	D
WBC2736	Cabinet	27	36	12
	Door	12 9/16	35	3/4

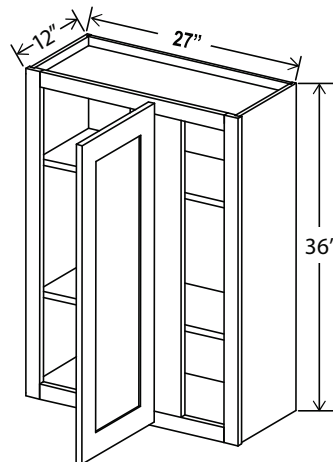

*Three adjustable shelves
Can be pulled for exact fit*

Wall Blind Corner Cabinet

42"H

Item Code		W	H	D
WBC2442	Cabinet	24	42	12
	Door	9 9/16	41	3/4
WBC2742	Cabinet	27	42	12
	Door	12 9/16	41	3/4
WBC3642	Cabinet	36	42	12
	Door	21 9/16	41	3/4

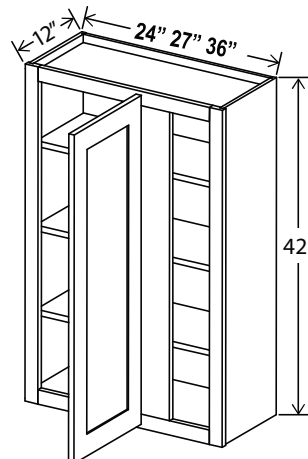

*Three adjustable shelves
Can be pulled for exact fit*

12"W

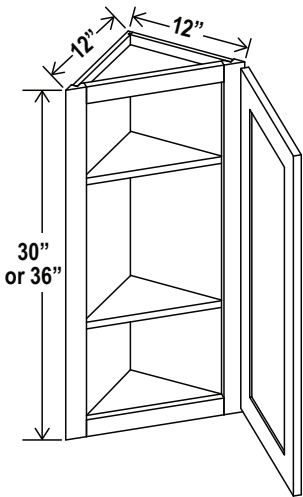

Two adjustable shelves

Angle Wall Cabinet

Item Code		W	H	D
AW1230	Cabinet	12	30	12
	Door	15 3/5	29	3/4
AW1236	Cabinet	12	36	12
	Door	15 3/5	35	3/4

12"W

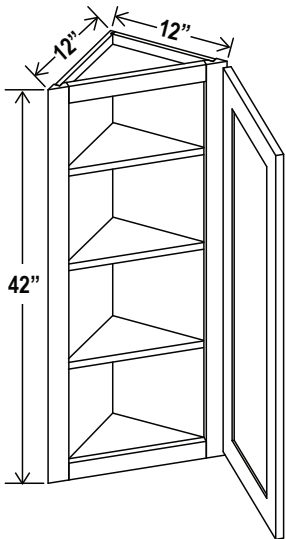

Three adjustable shelves

Angle Wall Cabinet

Item Code		W	H	D
AW1242	Cabinet	12	42	12
	Door	15 3/5	41	3/4

30"W

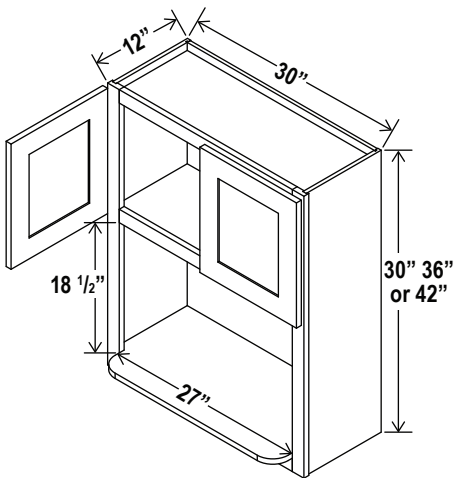

Microwave Wall Cabinet

Item Code		W	H	D
M03030	Cabinet	30	30	12
	Door	14 3/4	9 1/4	3/4
M03036	Cabinet	30	36	12
	Door	14 3/4	15 1/4	3/4
M03042	Cabinet	30	42	12
	Door	14 3/4	21 1/4	3/4
Opening Dimensions: 27 W x 18 1/2 H				

Refrigerator Wall Cabinet Double Doors

30"W

Item Code		W	H	D
W301224	Cabinet	30	12	24
	Door	14 3/4	11	3/4
W301524	Cabinet	30	15	24
	Door	14 3/4	14	3/4
W301824	Cabinet	30	18	24
	Door	14 3/4	17	3/4

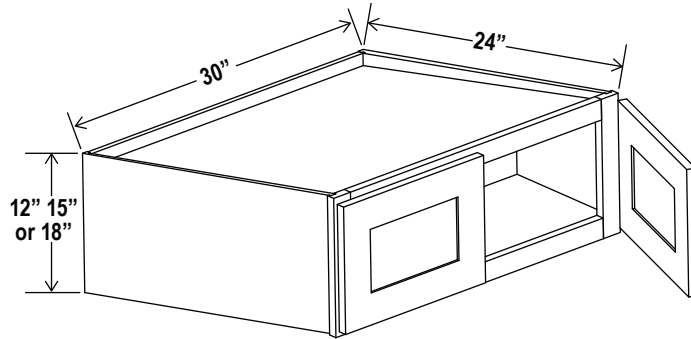

No Shelf

Refrigerator Wall Cabinet Double Doors

24"H

Item Code		W	H	D
W302424	Cabinet	30	24	24
	Door	14 3/4	23	3/4
W332424	Cabinet	33	24	24
	Door	16 1/4	23	3/4
W362424	Cabinet	36	24	24
	Door	17 3/4	23	3/4

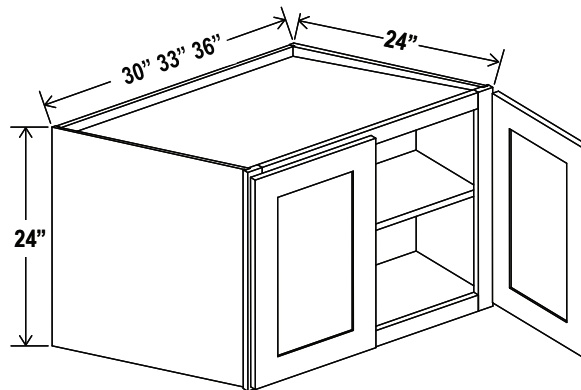

One adjustable shelf

Refrigerator Wall Cabinet Double Doors

33"W

Item Code		W	H	D
W331224	Cabinet	33	12	24
	Door	16 1/4	11	3/4
W331524	Cabinet	33	15	24
	Door	16 1/4	14	3/4
W331824	Cabinet	33	18	24
	Door	16 1/4	17	3/4

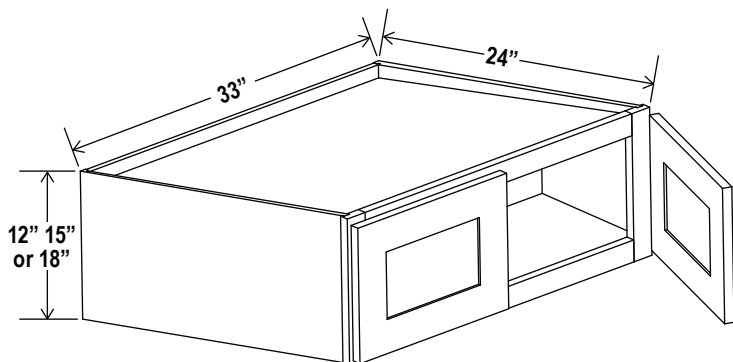

No Shelf

36"W

Refrigerator Wall Cabinet Double Doors

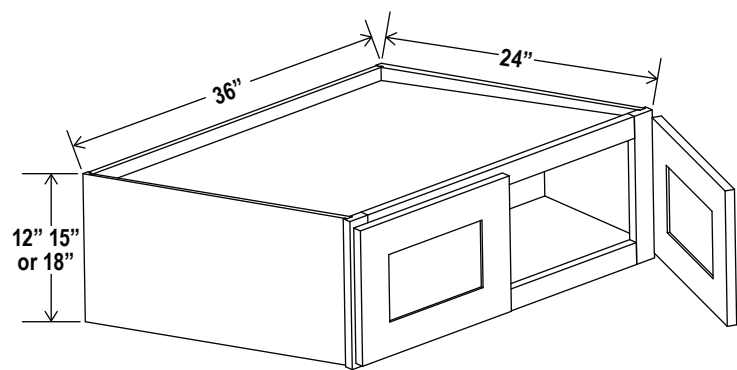

Item Code		W	H	D
W361224	Cabinet	36	12	24
	Door	17 3/4	11	3/4
W361524	Cabinet	36	15	24
	Door	17 3/4	14	3/4
W361824	Cabinet	36	18	24
	Door	17 3/4	17	3/4

No Shelf

Plate Rack

15"H

Item Code		W	H	D
PR3015	Cabinet	30	15	12

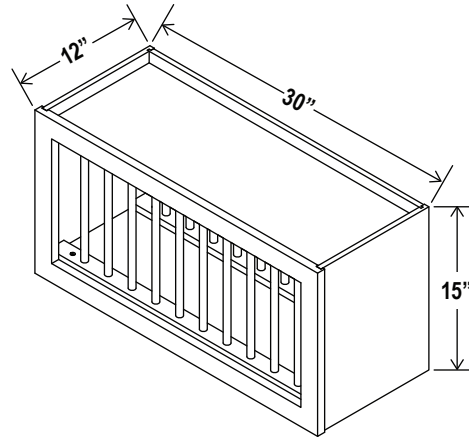

11 plate slots

Wall Spice Drawer

6"H

Item Code		W	H	D
WSD630	Cabinet	30	6	12

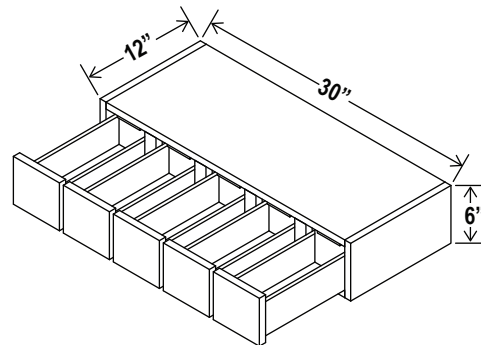

5 drawers

Wine Rack

30"W

Item Code		W	H	D
WRC3015	Cabinet	30	15	12
WRC3018	Cabinet	30	18	12

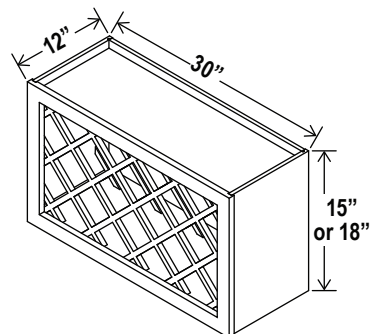

Can install vertically or horizontally

30”H

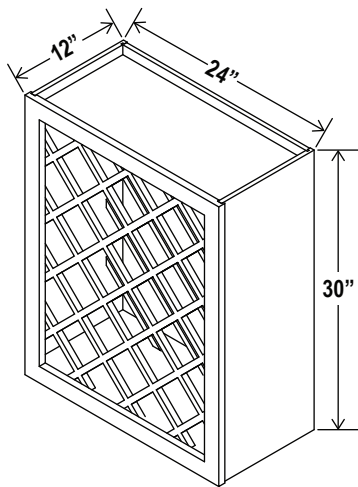

Wine Rack

Item Code		W	H	D
WRC2430	Cabinet	24	30	12

Can install vertically or horizontally

6”W

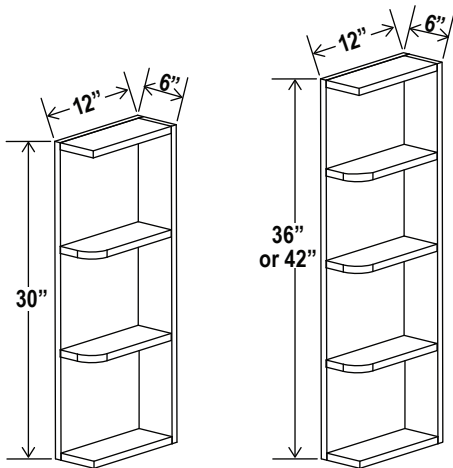

Open End Shelf

Item Code		W	H	D
OE630	Cabinet	6	30	12
OE636	Cabinet	6	36	12
OE642	Cabinet	6	42	12

Matching color interior

Base Cabinet Single Door

Item Code		W	H	D
B12	Cabinet	12	34 1/2	24
	Door	11 1/2	22 1/2	3/4
	Drawer	11 1/2	6 1/4	3/4
B15	Cabinet	15	34 1/2	24
	Door	14 1/2	22 1/2	3/4
	Drawer	14 1/2	6 1/4	3/4
B18	Cabinet	18	34 1/2	24
	Door	17 1/2	22 1/2	3/4
	Drawer	17 1/2	6 1/4	3/4
B21	Cabinet	21	34 1/2	24
	Door	20 1/2	22 1/2	3/4
	Drawer	20 1/2	6 1/4	3/4

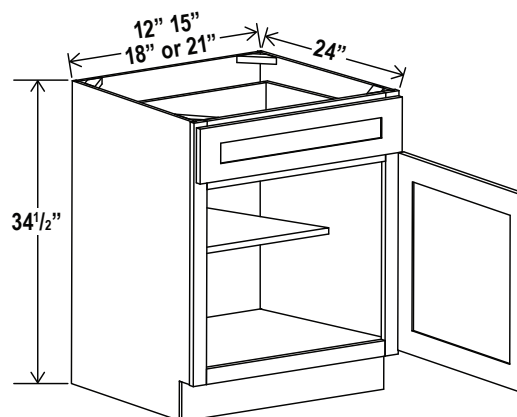

One drawer

Base Cabinet Double Doors

Item Code		W	H	D
B24	Cabinet	24	34 1/2	24
	Door	11 3/4	22 1/2	3/4
	Drawer	23 1/2	6 1/4	3/4
B27	Cabinet	27	34 1/2	24
	Door	13 1/4	22 1/2	3/4
	Drawer	26 1/2	6 1/4	3/4

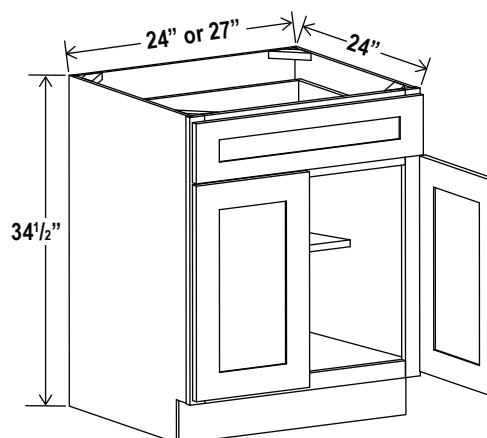

One drawer

Base Cabinet Double Doors

Item Code		W	H	D
B30	Cabinet	30	34 1/2	24
	Door	14 3/4	22 1/2	3/4
	Drawer	14 3/4	6 1/4	3/4
B33	Cabinet	33	34 1/2	24
	Door	16 1/4	22 1/2	3/4
	Drawer	16 1/4	6 1/4	3/4
B36	Cabinet	36	34 1/2	24
	Door	17 3/4	22 1/2	3/4
	Drawer	17 3/4	6 1/4	3/4
B42	Cabinet	42	34 1/2	24
	Door	20 3/4	22 1/2	3/4
	Drawer	20 3/4	6 1/4	3/4

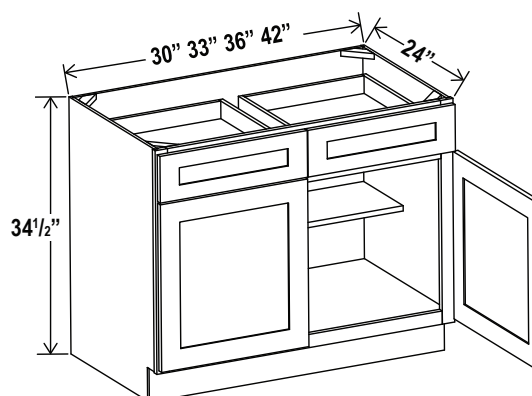

Two drawers

Drawer Base

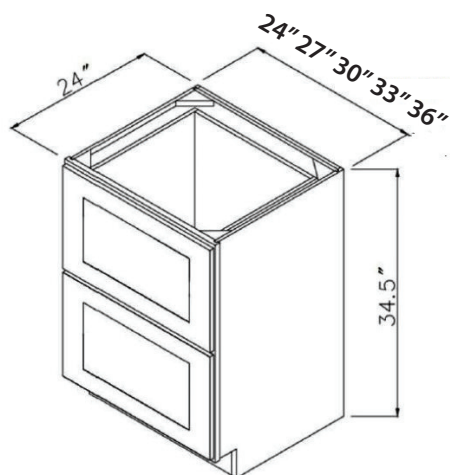
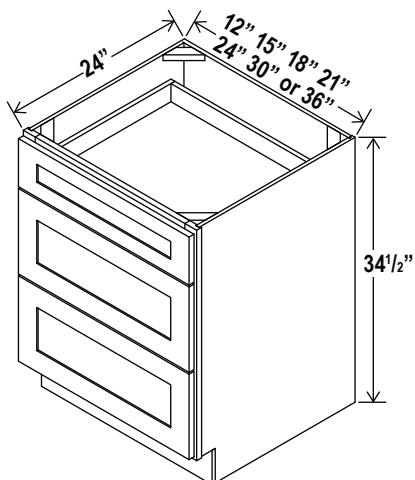

NB Only

NB Only

Item Code		W	H	D
3DB12	Cabinet	12	34 1/2	24
	Top Drawer	11 1/2	6 1/4	3/4
	Bottom Drawer	11 1/2	11 1/8	3/4
3DB15	Cabinet	15	34 1/2	24
	Top Drawer	14 1/2	6 1/4	3/4
	Bottom Drawer	14 1/2	11 1/8	3/4
3DB18	Cabinet	18	34 1/2	24
	Top Drawer	17 1/2	6 1/4	3/4
	Bottom Drawer	17 1/2	11 1/8	3/4
3DB21	Cabinet	21	34 1/2	24
	Top Drawer	20 1/2	6 1/4	3/4
	Bottom Drawer	20 1/2	11 1/8	3/4
3DB24	Cabinet	24	34 1/2	24
	Top Drawer	23 1/2	6 1/4	3/4
	Bottom Drawer	23 1/2	11 1/8	3/4
3DB27	Cabinet	27	34 1/2	24
	Top Drawer	26 1/2	6 1/4	3/4
	Bottom Drawer	26 1/2	11 1/8	3/4
3DB30	Cabinet	30	34 1/2	24
	Top Drawer	29 1/2	6 1/4	3/4
	Bottom Drawer	29 1/2	11 1/8	3/4
3DB33	Cabinet	33	34 1/2	24
	Top Drawer	32 1/2	6 1/4	3/4
	Bottom Drawer	32 1/2	11 1/8	3/4
3DB36	Cabinet	36	34 1/2	24
	Top Drawer	35 1/2	6 1/4	3/4
	Bottom Drawer	35 1/2	11 1/8	3/4

Document File Base Cabinet

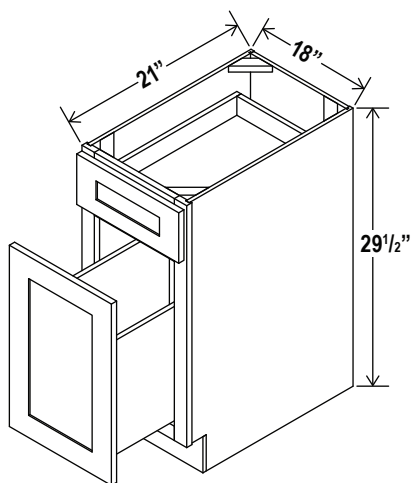

Item Code		W	H	D
DFB18	Cabinet	18	29 1/2	21
	Top Drawer	17 1/2	6 1/4	3/4
	Bottom Drawer	17 1/2	17 1/2	3/4

Blind Corner Base Cabinet

Item Code		W	H	D
BBC36	Cabinet	33	34 1/2	24
	Door	10	22 1/2	3/4
	Drawer	10	6 1/4	3/4
Install range: 36" - 39"				
BBC39	Cabinet	36	34 1/2	24
	Door	12 3/4	22 1/2	3/4
	Drawer	12 3/4	6 1/4	3/4
Install range: 39" - 42"				
BBC42	Cabinet	39	34 1/3	24
	Door	15 3/4	22 1/2	3/4
	Drawer	15 3/4	6 1/4	3/4
Install range: 42" - 45"				

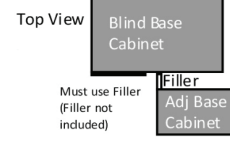
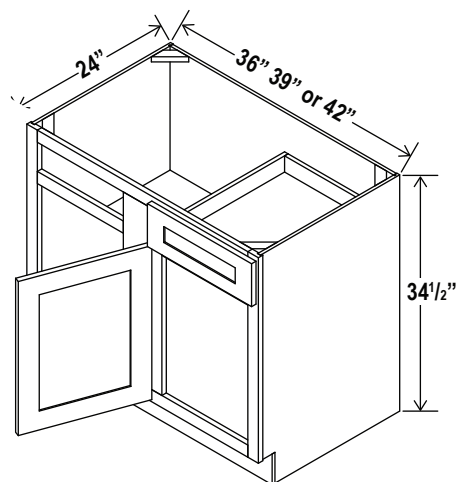

BBC36 36"-39"
BBC39 39"-42"
BBC42 42"-45"

Easy Reach Base Cabinet

Item Code		W	H	D
ERB33	Cabinet	33	34 1/2	24
	Door	7 5/8	29	3/4
ERB36	Cabinet	36	34 1/2	24
	Door	10 5/8	29	3/4

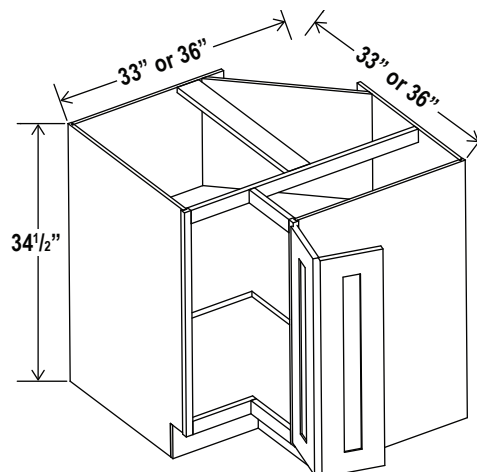

One bi-fold door

Wood Tray/ Chrome Tray

Item Code
Wood Tray
Chrome Tray 33
Chrome Tray 36

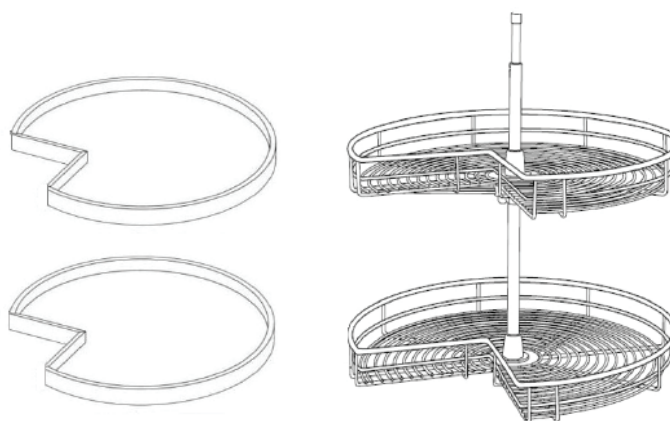

Add to ERB for Lazy Susan
** NOTE: Wood tray does not have a pole included in the middle
Wood Tray *** Can be used in frameless line. Fits both 33" and 36"
Trays are shelf mounted

Base End Cabinet

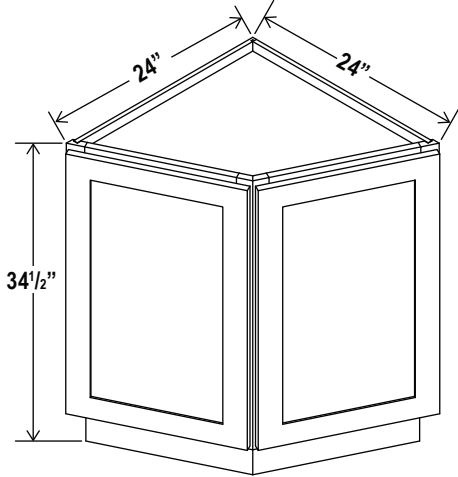

Item Code		W	H	D
BEC24	Cabinet	24	34 1/2	24
	Door	17 1/2	29	3/4

Base Tray

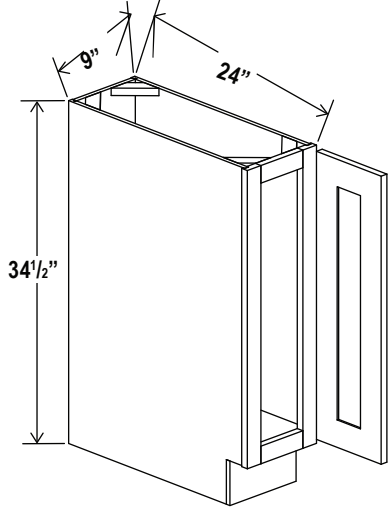

Item Code		W	H	D
BT09	Cabinet	9	34 1/2	24
	Door	8 1/2	29	3/4

Sink Base

Item Code		W	H	D
SB27	Cabinet	27	34 1/2	24
	Door	13 1/4	22 1/2	3/4
	Drawer	26 1/2	6 1/4	3/4

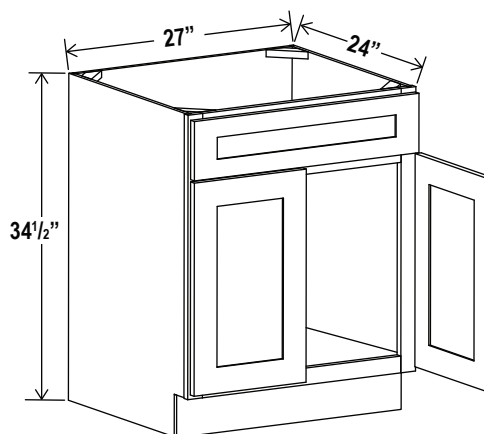

One dummy drawer

Sink Base

Item Code		W	H	D
SB30	Cabinet	30	34 1/2	24
	Door	14 3/4	22 1/2	3/4
	Drawer	14 3/4	6 1/4	3/4
SB33	Cabinet	33	34 1/2	24
	Door	16 1/4	22 1/2	3/4
	Drawer	16 1/4	6 1/4	3/4
SB36	Cabinet	36	34 1/2	24
	Door	17 3/4	22 1/2	3/4
	Drawer	17 3/4	6 1/4	3/4

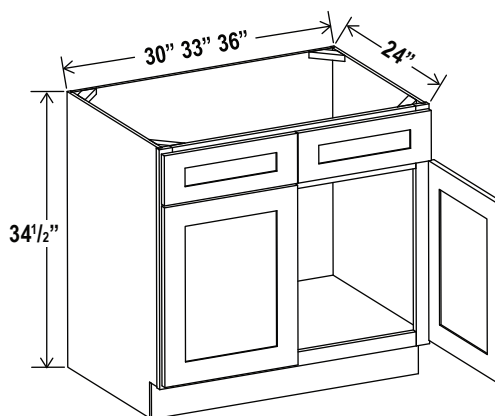

Two dummy drawers

Farmhouse Sink Base

Item Code		W	H	D
FSB36	Cabinet	36	34 1/2	24
	Door	17 3/4	16 1/2	3/4
Sink Trimout: 30"W X 7 1/2"-9"H				

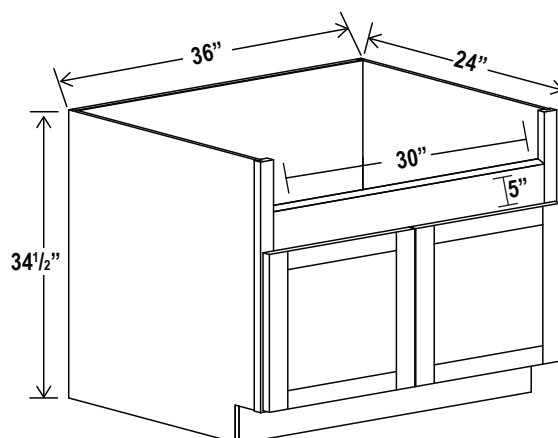

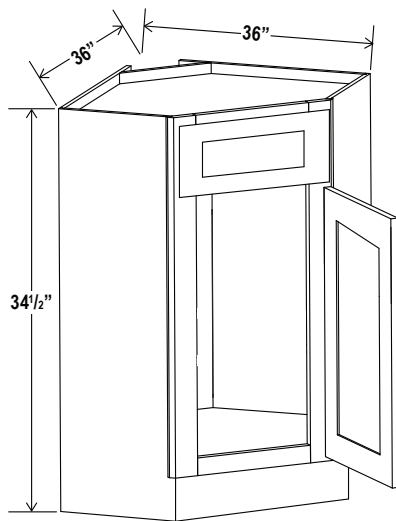

Corner Sink Base Cabinet

Item Code		W	H	D
CSB36	Cabinet	36	34 1/2	24
	Door	15 1/4	22 1/4	3/4
	Drawer	15 1/4	6 1/4	3/4

One dummy drawer

Corner Sink Base Floor

Item Code		W
SBF4242	Cabinet	42

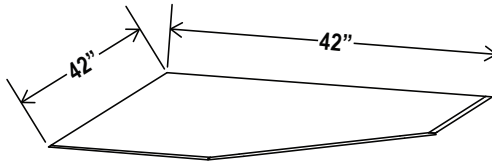

For use with DCSF42

Corner Sink Base Front

Item Code		W	H	D
DCSF42	Cabinet	26 1/4	30	3/4
	Door	11 3/4	22 1/2	3/4
	Drawer	23 1/2	6 1/4	3/4

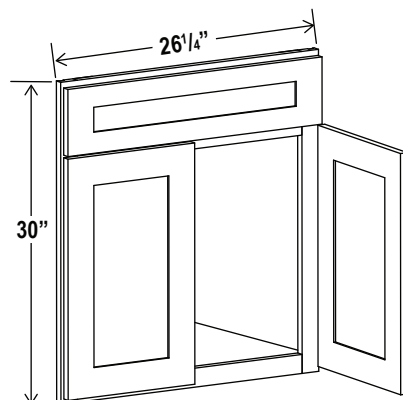

For use with SBF4242

Base Waste Basket Cabinet

Item Code		W	H	D
BWB18	Cabinet	18	34 1/2	24
	Top Drawer	17 1/2	6 1/4	3/4
	Bottom Drawer	17 1/2	22 1/2	3/4

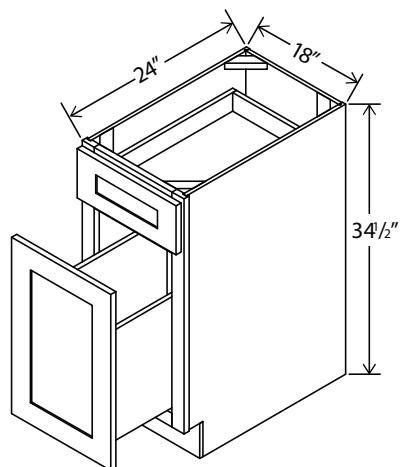

Waste baskets not included

Microwave Base Cabinet

Item Code		W	H	D
MB30	Cabinet	30	34 1/2	24
	Drawer	29 1/2	10 1/2	3/4
	Opening Dimensions: 27"W x 17"H			
MB33	Cabinet	33	34 1/2	24
	Drawer	32 1/2	10 1/2	3/4
	Opening Dimensions: 30"W x 17"H			

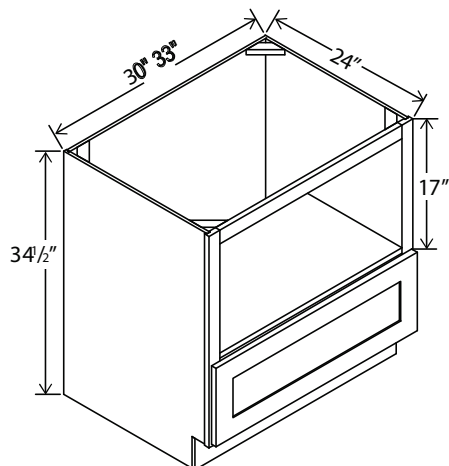

Finished Interiors

Spice Pull Base Cabinet

Item Code		W	H	D
SPB6	Cabinet	6	34 1/2	24
	Drawer	5 1/2	29	3/4
SPB9	Cabinet	9	34 1/2	24
	Drawer	8 1/2	29	3/4

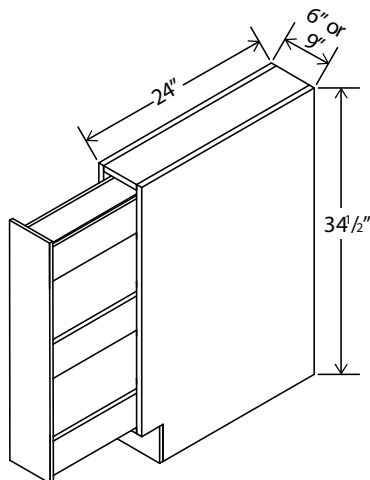

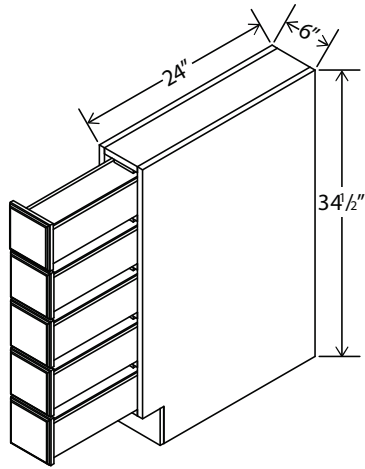

Base Spice Drawer

Item	Code	W	H	D
BSDC6	Cabinet	6	34 1/2	24

Natural interior finish

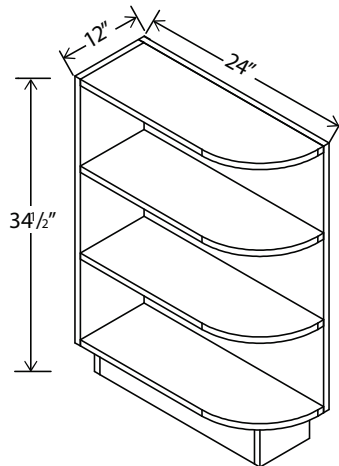

Base End Shelf

Item	Code	W	H	D
BES12	Cabinet	12	34 1/2	24

Utility Pantry

18"W

Item Code		W	H	D
U188424	Cabinet	18	84	24
	Top Door	17 1/2	29	3/4
	Bottom Door	17 1/2	49 1/4	3/4
U189024	Cabinet	18	90	24
	Top Door	17 1/2	35	3/4
	Bottom Door	17 1/2	49 1/4	3/4
U189624	Cabinet	18	96	24
	Top Door	17 1/2	41	3/4
	Bottom Door	17 1/2	49 1/4	3/4

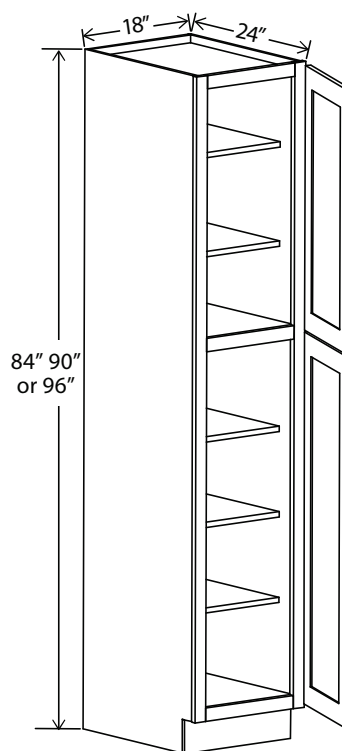

Two doors
Two adjustable top shelves
Three bottom shelves
Note: Roll out shelf kits available

24"W

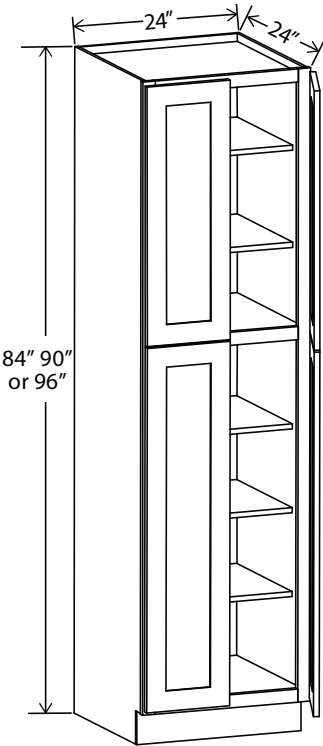

Utility Pantry

Item Code		W	H	D
U248424	Cabinet	24	84	24
	Top Door	11 3/4	29	3/4
	Bottom Door	11 3/4	49 1/4	3/4
U249024	Cabinet	24	90	24
	Top Door	11 3/4	35	3/4
	Bottom Door	11 3/4	49 1/4	3/4
U249624	Cabinet	24	96	24
	Top Door	11 3/4	41	3/4
	Bottom Door	11 3/4	49 1/4	3/4

Four doors
Two adjustable top shelves
Three bottom shelves
Note: Roll out shelf kits available

Utility Pantry

30"W

Item Code		W	H	D
U308424	Cabinet	30	84	24
	Top Door	14 3/4	29	3/4
	Bottom Door	14 3/4	49 1/4	3/4
U309024	Cabinet	30	90	24
	Top Door	14 3/4	35	3/4
	Bottom Door	14 3/4	49 1/4	3/4
U309624	Cabinet	30	96	24
	Top Door	14 3/4	41	3/4
	Bottom Door	14 3/4	49 1/4	3/4

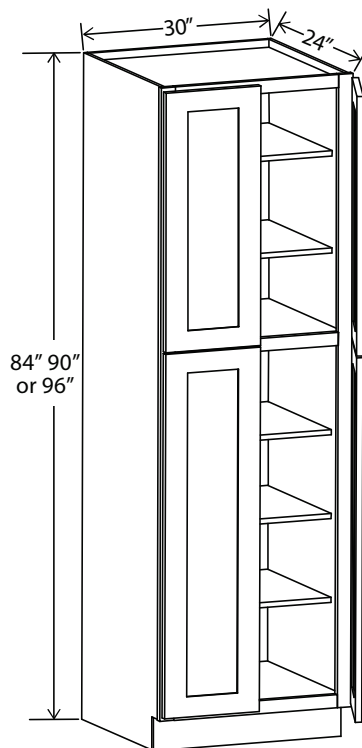

Four doors
Two adjustable top shelves
Three bottom shelves
Note: Roll out shelf kits available

30"W

Oven Pantry

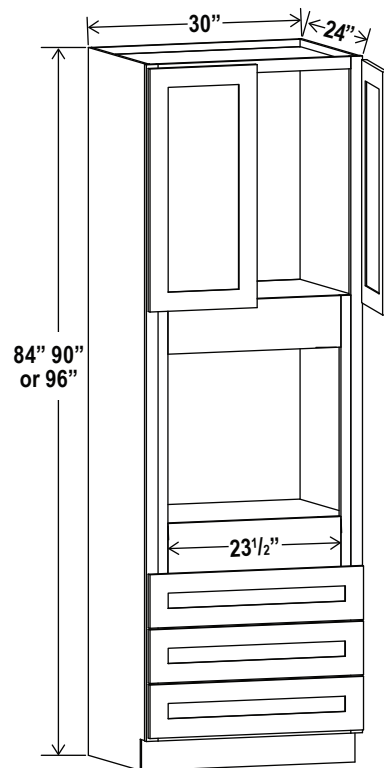

Item Code		W	H	D
0308424	Cabinet	30	84	24
	Door	14 3/4	17	3/4
	Drawer	29 1/2	7 3/4	3/4
	Opening Dimensions : 24 W x 24 3/8 H			
0309024	Cabinet	30	90	24
	Door	14 3/4	23	3/4
	Drawer	29 1/2	7 3/4	3/4
	Opening Dimensions : 24 W x 24 3/8 H			
0309624	Cabinet	30	96	24
	Door	14 3/4	29	3/4
	Drawer	29 1/2	7 3/4	3/4
	Opening Dimensions : 24 W x 24 3/8 H			

Two doors
One large open shelf
Three bottom drawers
Note: Drawers may be removed to accommodate double ovens.

Oven Pantry

33"W

Item Code		W	H	D
0338424	Cabinet	33	84	24
	Door	16 1/4	17	3/4
	Drawer	32 1/2	7 3/4	3/4
	Opening Dimensions: 27 W x 34 1/2" H			
0339024	Cabinet	33	90	24
	Door	16 1/4	23	3/4
	Drawer	32 1/2	7 3/4	3/4
	Opening Dimensions: 27 W x 34 1/2" H			
0339624	Cabinet	33	96	24
	Door	16 1/4	29	3/4
	Drawer	32 1/2	7 3/4	3/4
	Opening Dimensions: 27 W x 34 1/2" H			

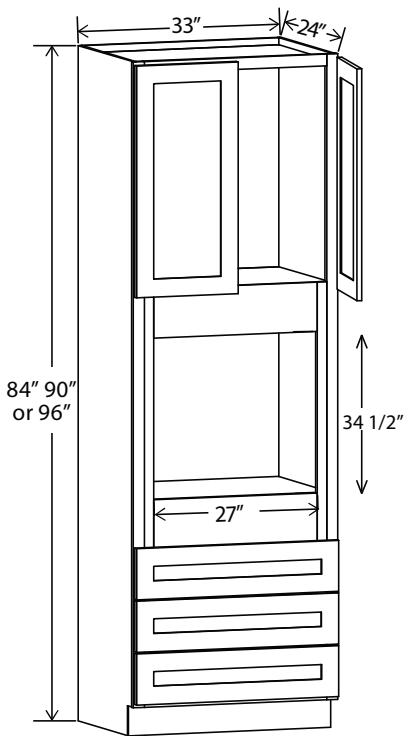

Two doors
One large open shelf
Three bottom drawers

Note: Drawers may be removed to accommodate double ovens.

Vanity Sink Base

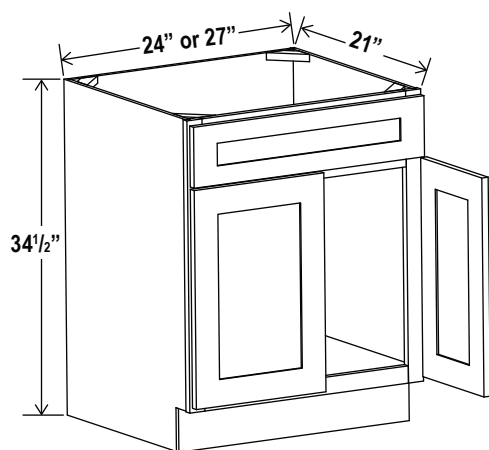

Item Code		W	H	D
VS24	Cabinet	24	34 1/2	21
	Door	11 3/4	22 1/2	3/4
	Drawer	23 1/4	6 1/4	3/4
VS27	Cabinet	27	34 1/2	21
	Door	13 1/4	22 1/3	3/4
	Drawer	26 1/2	6 1/4	3/4

One dummy drawer

Vanity Sink Base

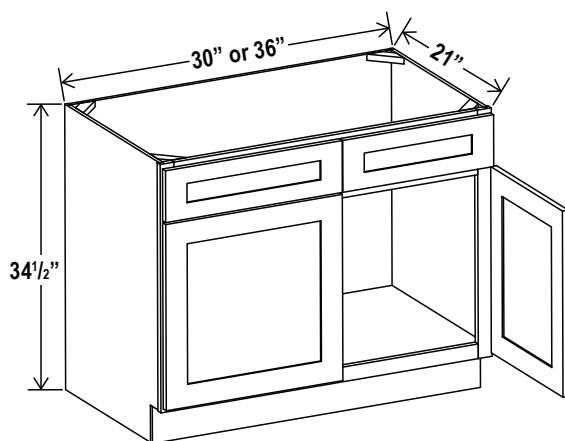

Item Code		W	H	D
VS30	Cabinet	30	34 1/2	21
	Door	14 3/4	22 1/2	3/4
	Drawer	14 3/4	6 1/4	3/4
VS36	Cabinet	36	34 1/2	21
	Door	17 3/4	22 1/2	3/4
	Drawer	17 3/4	6 1/4	3/4

Two dummy drawers

Vanity Drawer Base Cabinet

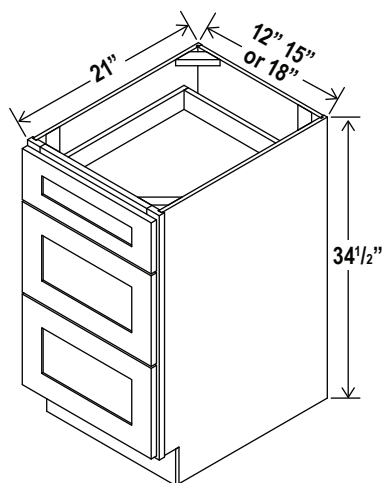

Item Code		W	H	D
3VDB12	Cabinet	12	34 1/2	21
	Top Drawer	11 1/2	6 1/4	3/4
	Bottom Drawer	11 1/2	11 1/8	3/4
3VDB15	Cabinet	15	34 1/2	21
	Top Drawer	14 1/2	6 1/4	3/4
	Bottom Drawer	14 1/2	11 1/8	3/4
3VDB18	Cabinet	18	34 1/2	21
	Top Drawer	17 1/2	6 1/4	3/4
	Bottom Drawer	17 1/2	11 1/8	3/4

Vanity Combo

Item Code		W	H	D
VSD36	Cabinet	36	34 1/2	21
	Door	17 3/4	22 1/2	3/4
	Outside Drawer	10 1/4	6 1/4	3/4
	Center Drawer	14 1/2	6 1/4	3/4
VSD42	Cabinet	42	34 1/2	21
	Door	20 3/4	22 1/2	3/4
	Outside Drawer	11 1/2	6 1/4	3/4
	Center Drawer	18	6 1/4	3/4
VSD48	Cabinet	48	34 1/2	21
	Door	23 3/4	22 1/2	3/4
	Outside Drawer	14 1/2	6 1/4	3/4
	Center Drawer	18	6 1/4	3/4

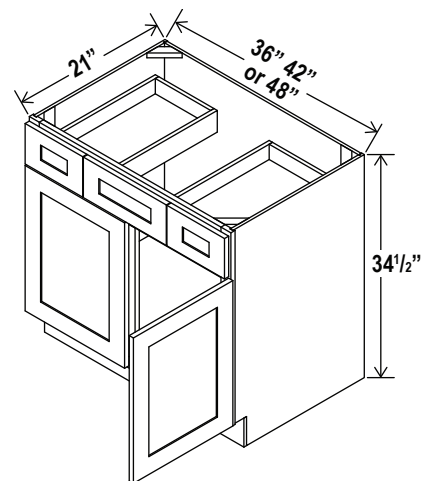

Vanity Combo

Item Code		W	H	D
V3021DL	Cabinet	30	34 1/2	21
	Door	17 1/2	22 1/2	3/4
	Long Drawer	17 1/2	6 1/4	3/4
	Top Drawer	11 1/2	6 1/4	3/4
	Bottom Drawer	11 1/2	11 1/8	3/4
V3021DR	Cabinet	30	34 1/2	21
	Door	17 1/2	22 1/2	3/4
	Long Drawer	17 1/2	6 1/4	3/4
	Top Drawer	11 1/2	6 1/4	3/4
	Bottom Drawer	11 1/2	11 1/8	3/4

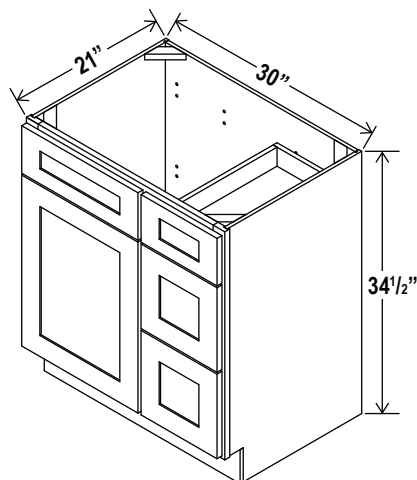
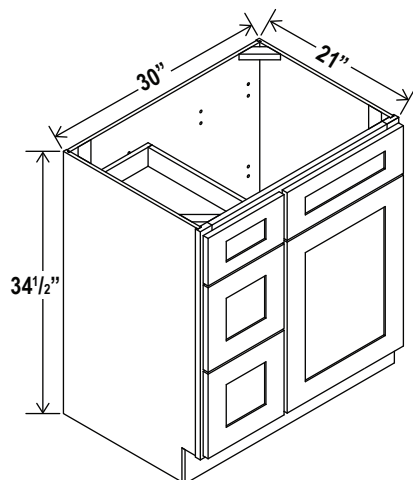

V3021DL: 30" combo with drawers on left
V3021DR: 30" combo with drawers on right

Vanity Combo

Item Code		W	H	D
V3621DL	Cabinet	36	34 1/2	21
	Door	11 3/4	22 1/2	3/4
	Long Drawer	23 1/2	6 1/4	3/4
	Top Drawer	11 1/2	6 1/4	3/4
	Bottom Drawer	11 1/2	11 1/8	3/4
V3621DR	Cabinet	36	34 1/2	21
	Door	11 3/4	22 1/2	3/4
	Long Drawer	23 1/2	6 1/4	3/4
	Top Drawer	11 1/2	6 1/4	3/4
	Bottom Drawer	11 1/2	11 1/8	3/4

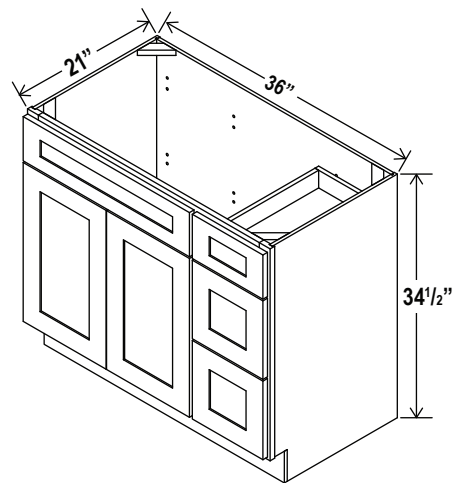
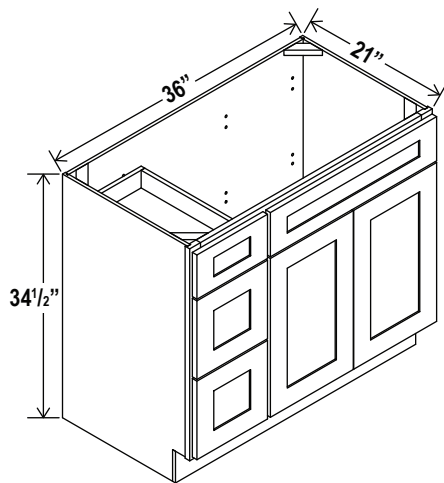

V3621DL: 36" combo with drawers on left
V3621DR: 36" combo with drawers on right

Rope Moulding

Item Code	L
ROPE	96

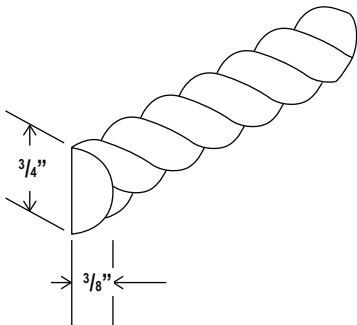

Dentil Moulding

Item Code	L
DMTIS	96

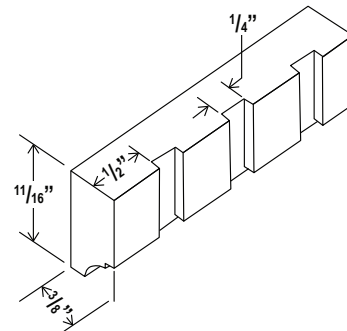

Furniture Base

Item Code	L
FBM	96

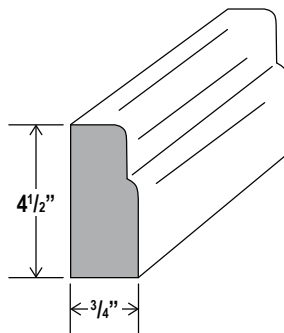

Cove Crown Moulding

Item Code	L
COV	96

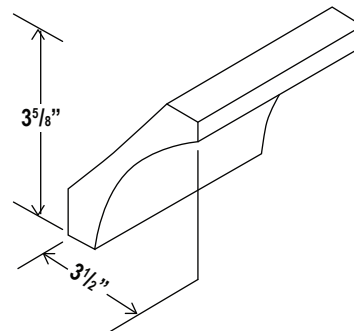

Decorative Moulding

Item Code	L
BCM8(DCM)	96

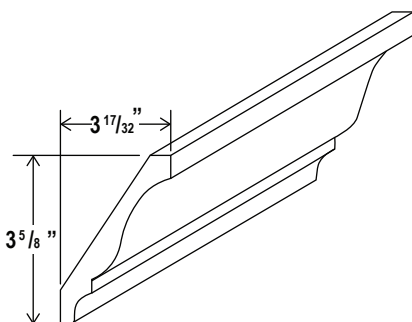

Crown Moulding

Item Code	L
CM8	96

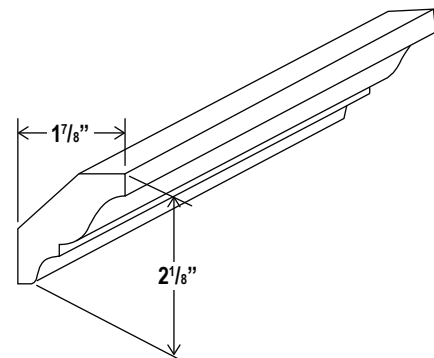

Inset Crown Moulding

Item Code	L
RCM4S(LCM)	96

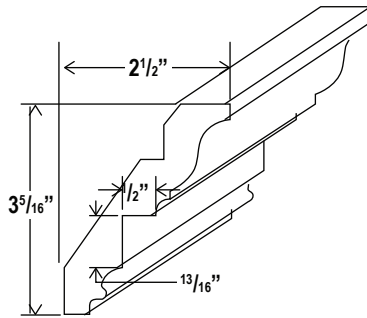

Angle Crown Moulding

Item Code	L
ACM8	96

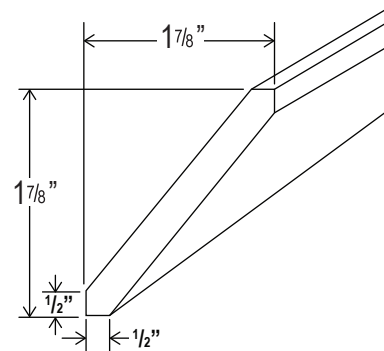

Angle Light Rail Moulding

Item Code	L
ALRM8	96

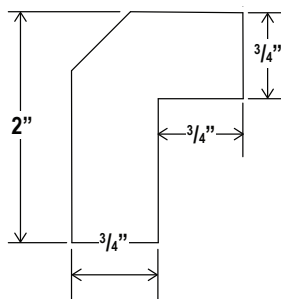

Light Rail Moulding

Item Code	L
LRM8	96

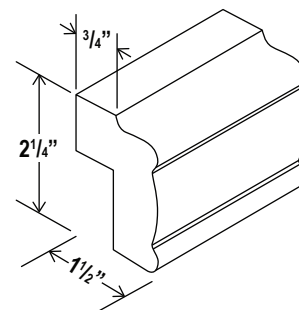

Outside Corner Moulding

Item Code	L
OCM8	96

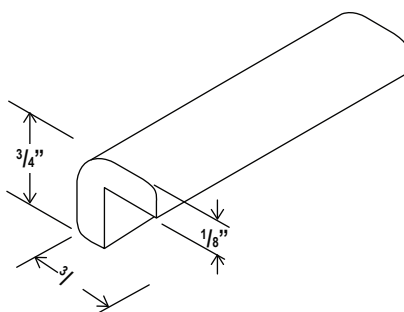

Shoe Moulding

Item Code	L
SHM	96

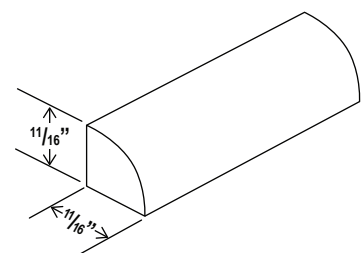

Scribe Moulding

Item Code	L
SM8(SCR)	96

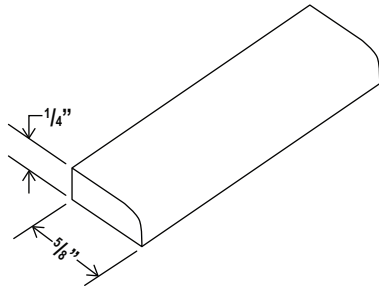

Batten Moulding

Item Code	L
BAM	96

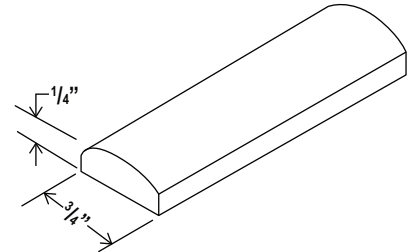

Toe Kick

Item Code	L
TKC	96

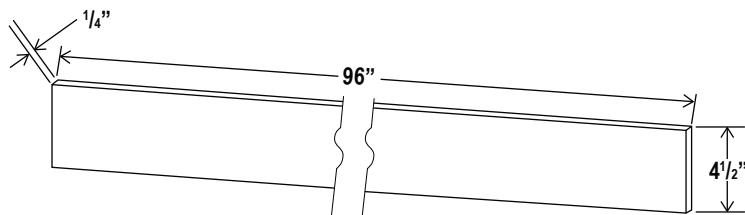

Tall Filler

Item Code	L
F396	96
F696	96

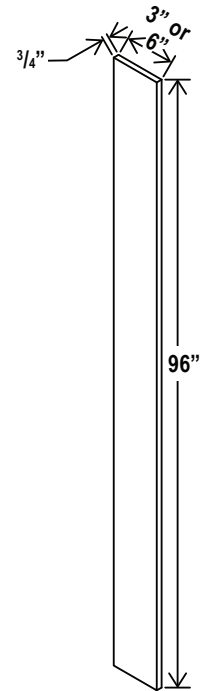

Filler

Item Code	L
F342	42
F642	42

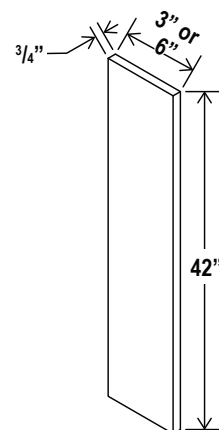

Finish Plywood Panel

Item Code	L
FPV4296	96

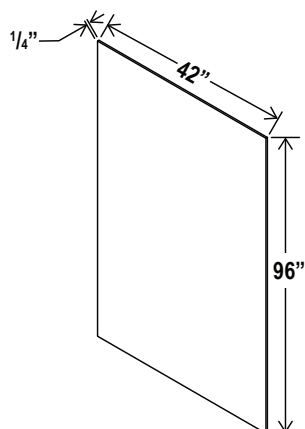

Note: Edges are not finished

Tall Skin Veneer Panel

Item Code	L
USV2496	96

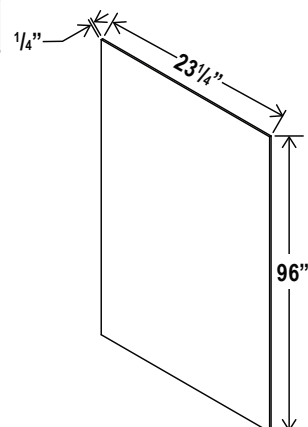

Note: Edges are not finished

Base Skin Veneer Panel

Item Code	L
BSV	34 1/2

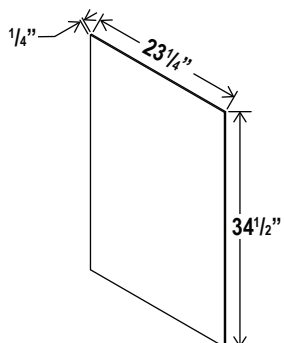

Note: Edges are not finished

Wall Skin Panel

Item Code	L
WSV42	42

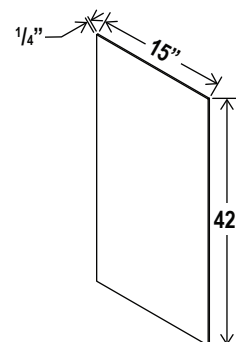

Note: Edges are not finished

Dishwasher Return Panel

Item Code	L
DWR3	34 1/2

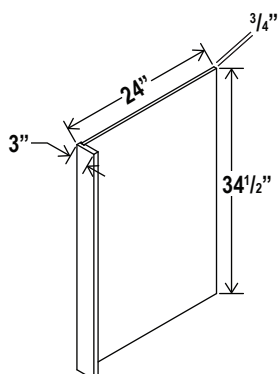

Note: Edges are not finished

Refrigerator End Panel

Item Code	L
REPV2496	96
REPV2796	96

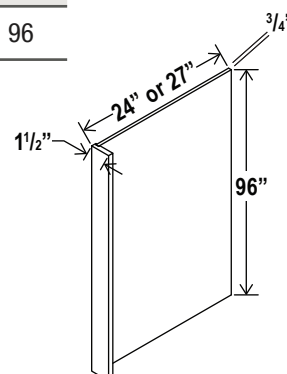

Note: Edges are not finished

Tall Decorative Door Panel

Item Code	L
TDEP2484	78 1/2
TDEP2490	84 1/2
TDEP2496	90 1/2

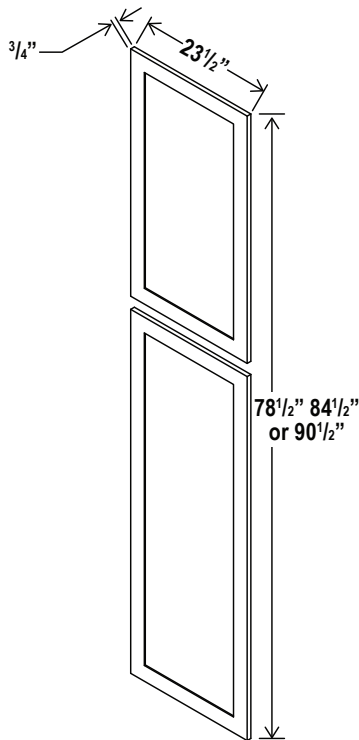

Wall Decorative Door Panel

Item Code	L
WDEP30	29
WDEP36	35
WDEP42	41

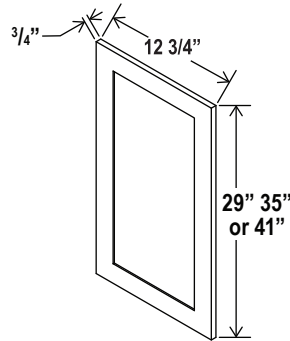

Base Decorative Door Panel

Item Code	L
BDEP	29

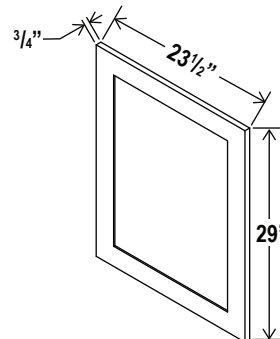

Shelf Board

Item Code	L
S2496	96

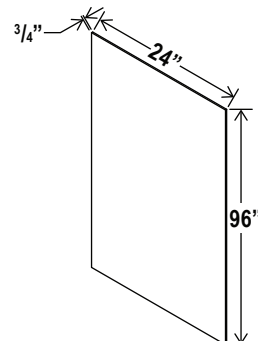

*Banded on both edges
Finished on all 4 sides
Color to match cabinet*

Corbel

Item Code

CB9

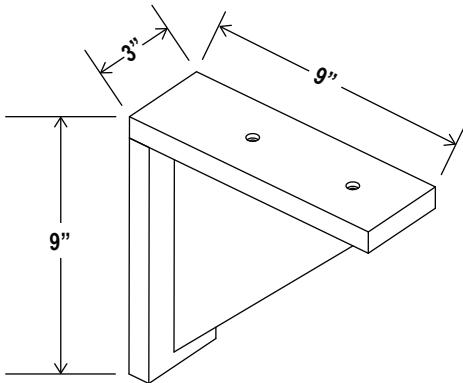

Corbel

Item Code

CBT

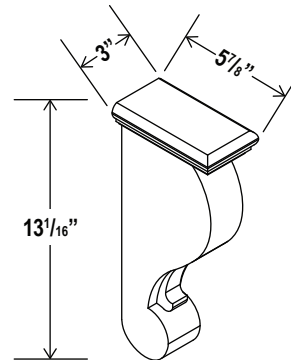

Classic Decorative Leg

Item Code

CLDL

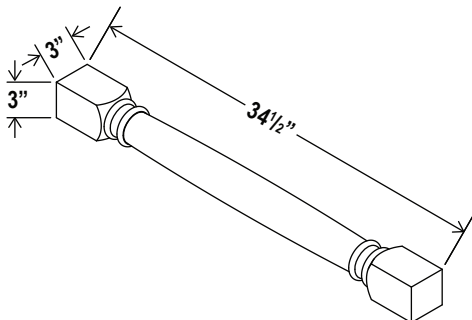

Fluted Decorative Leg

Item Code

FLDL

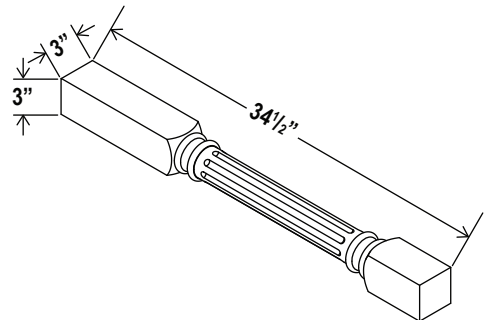

Glass Holder

Item Code

SGH30

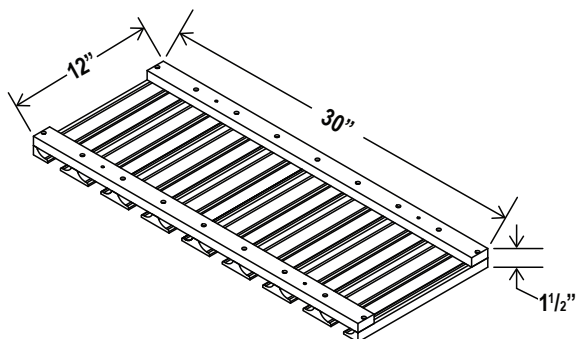

Knee Drawer

Item Code

VKD36

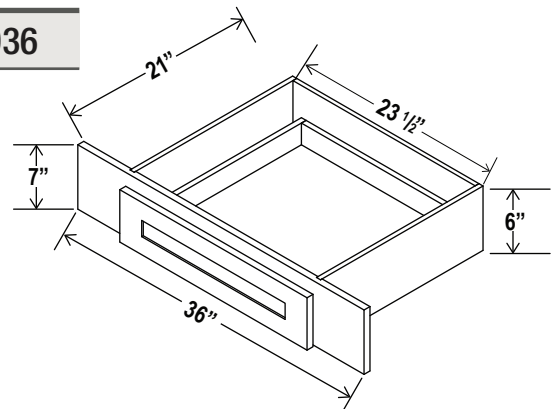

Note: Max trim to 30"

Note: Interior Drawer Dimensions 3 1/2" x 18 1/4" x 20 1/4"

Arched Valance

Item Code

VA30

VA36

VA42

VA48

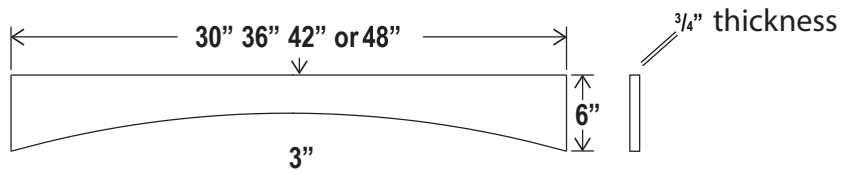

Roll Out Tray

Item Code

RS18

RS21

RS24

RS27

RS30

RS33

RS36

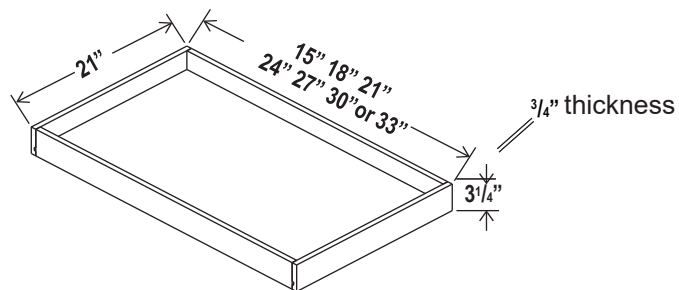

Note: Natural finish. Side mount only.

Sample Door

Item Code

SD

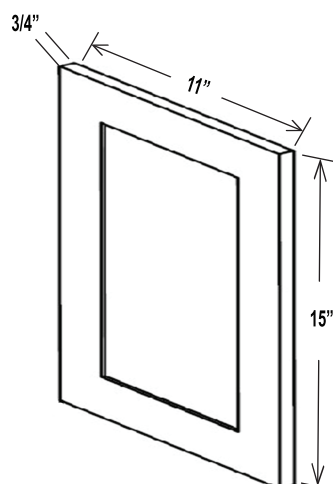



SKYLINE[®]

C A B I N E T R Y



12301 N. Stemmons Freeway, Suite 100 • Farmers Branch, TX 75234

Member



newclients@skylinecabinetry.com

(888) 860-0880

2001 Directors Row • Orlando, FL 32809

(407) 601-7090



www.skylinecabinetry.com